



eptarefrigeration

PLUG-IN POWER



AMAZE



Meat



Cheese



Dairy products



Fruits and Vegetables



Drinks



Frozen food



Ventilated



Hot-gas defrosting system



LED lighting



Free maintenance condenser



High efficiency fans



Medium & Low temperature



Electronic controller

www.epta-asiapacific.com



eptarefrigeration

PLUG-IN POWER



TECHNICAL DETAILS

| Model | Cabinet dimension L x W x H | Volume in litres | | Operating temperature | Refrigerant |
|-----------|--------------------------------|------------------|-----|-----------------------|------------------|
| | | Gross | Net | | |
| Amaze 130 | 1230 x 870 x 1056 | 409 | 334 | -18°/-25°C +5°/-1°C | R507A/R404A/R290 |
| Amaze 180 | 1810 x 870 x 1056 | 622 | 509 | -18°/-25°C +5°/-1°C | R507A/R404A/R290 |
| Amaze 210 | 2105 x 870 x 1056 | 731 | 597 | -18°/-25°C +5°/-1°C | R507A/R404A/R290 |

| Model | Packing dimension L x W x H | Quantity on container | | Cooling system | Defrosting system |
|-----------|--------------------------------|-----------------------|-------|----------------|-------------------|
| | | 20' | 40'HQ | | |
| Amaze 130 | 1345 x 1040 x 1190 | 14 | 34 | Ventilated | Automatic |
| Amaze 180 | 1925 x 1040 x 1190 | 10 | 24 | Ventilated | Automatic |
| Amaze 210 | 2220 x 1040 x 1190 | 9 | 22 | Ventilated | Automatic |

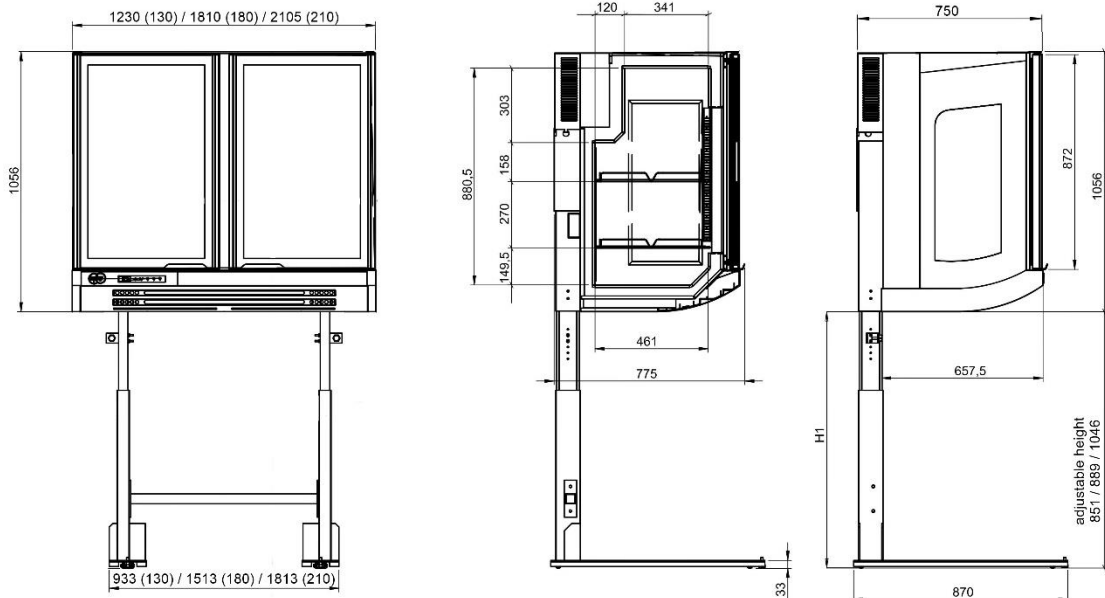

ACCESSORIES

| | STD | OPT |
|-----------------------------------|-----|-----|
| Adjustable shelves + bottom shelf | ● | |
| Adjustable stand | ● | |
| Solid side panel | | ● |
| Customized graphic | | ● |



eptarefrigeration

PLUG-IN POWER

